



SCOPE OF WORK:
1. NO CHANGE IN BULK, FLOOR AREA UNDER THIS APPLICATION.
SCOPE OF WORK INCLUDE:
- NEW INTERIOR PARTITIONS
- OPERATORY EQUIPMENT
- PLUMBING FIXTURES
- LIGHT FIXTURES
- FIRE PROTECTION SYSTEM
- EXTERIOR SIGNAGE
- NEW FINISHES

GENERAL NOTES:
1.THE SITE SHALL BE CLEANED AT FREQUENT INTERVALS AS NO MATERIAL SHALL BE STORED ON THE SITE IN A MANNER WHICH WOULD OBSTRUCT THE EASY ACCESS OF EQUIPMENT AND PERSONNEL.

2. THE CONTRACTOR SHALL VERIFY ALL CONDITIONS IN THE FIELD AND IMMEDIATELY NOTIFY THE ARCHITECT OF ANY CONDITIONS NOT AS ASSUMED. HE SHALL TAKE FIELD MEASUREMENTS AS REQUIRED AND BE RESPONSIBLE FOR SAME.

3. THE CONTRACTOR SHALL PROVIDE ALL NECESSARY SHORING AN BRACING OF EXISTING CONSTRUCTION, ETC., INCLUDING UTILITIES AS REQUIRED FOR THE SAFE INSTALLATION OF NEW CONSTRUCTION AND THE PROTECTION OF EXISTING CONDITIONS.

4. ALL STRUCTURAL WORK SHALL BE COORDINATED WITH ARCHITECTURAL AND ALL OTHER MECHANICAL REQUIREMENTS, DISCREPACIES AND/OR INTERFERENCES SHALL BE REPORTED TO THE ARTCHITECT IMMEDIATELY.

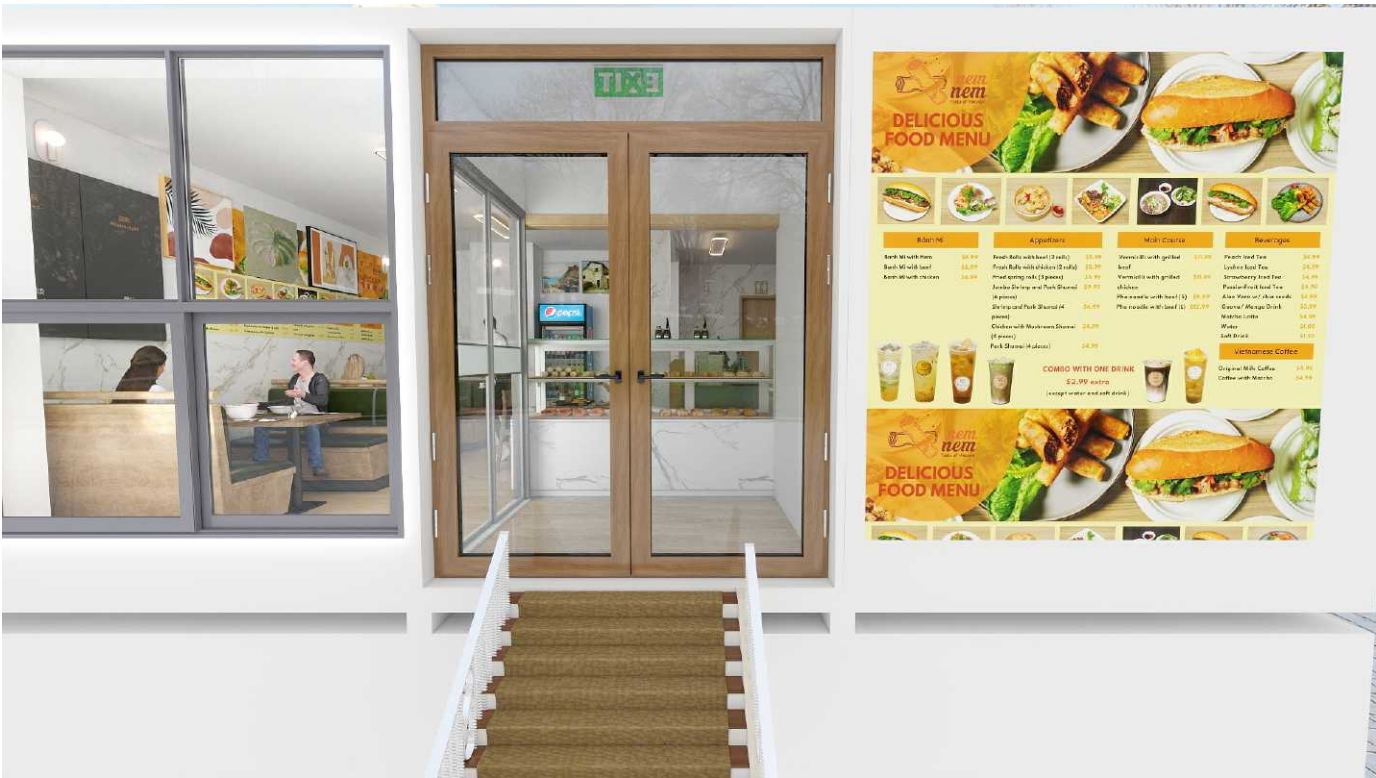

Enterprise Logo
General Notes
Architect / Designer
Anh Nhut Nguyen
Project Name
Nem Nem Restaurant
Client
Trang Nguyen
Client Address
555 RITSON, OSHAWA, ON
Project No.
Drawing No.
02